

PLAN SHOWING THE PROPOSED ADDITIONAL CONSTRUCTION TO EXISTING T.N.H.B M.I.G FLATS (Nos.E-1 To E-6, F-1 TO F-6, G-1 TO G-6, H-1 TO H-6, AND I-1 TO I-6) IN BLOCK Nos. E, F, G, H & I OF APOLLO COLONY AT ANNA NAGAR 7<sup>th</sup> AVENUE, IN S. No.226 PL.OF THIRUMANGALAM VILLAGE, (KOYAMBEDU COMES UNDER THIRUMANGALAM VILLAGE) MADRAS CORPORATION LIMITS. DIVISION NO. 64 (NEW)

Planning Permit No.                       
**APPROVED**  
 SUBJECT TO THE CONDITIONS IN THIS OFFICE LETTER  
 No.                      Date                       
 FOR MEMBER SECRETARY  
 MADRAS METROPOLITAN DEVELOPMENT AUTHORITY  
 MADRAS - 600 008.

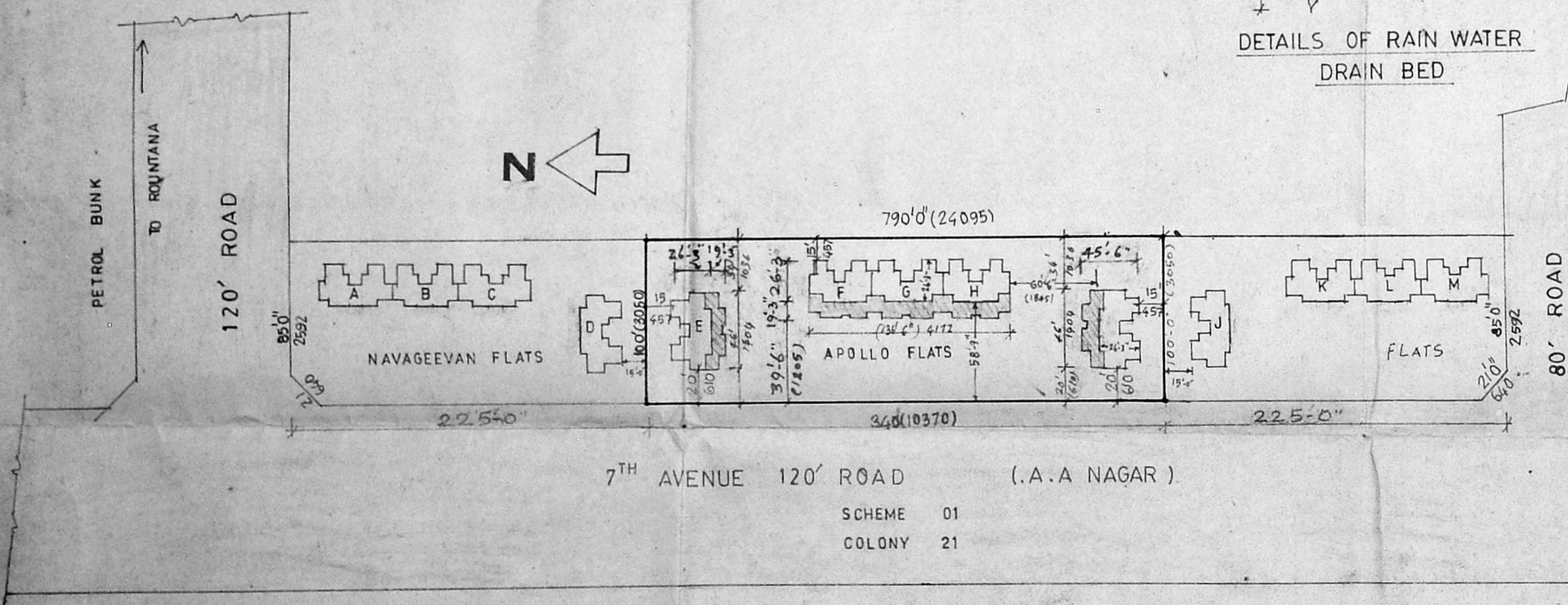

KEY PLAN  
 (NOT TO SCALE)

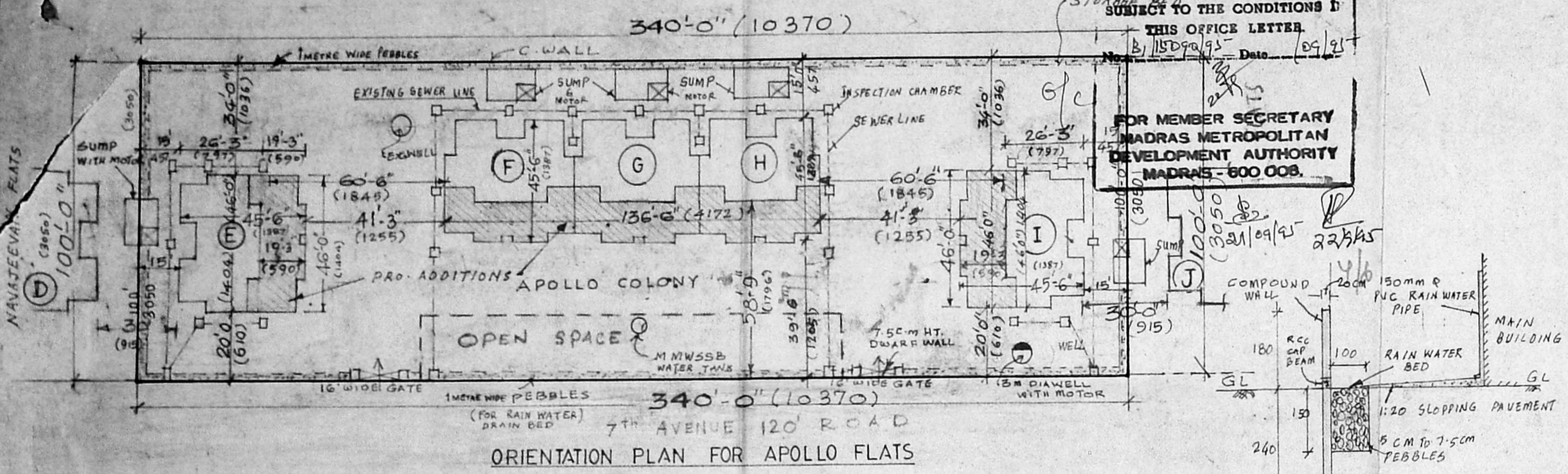
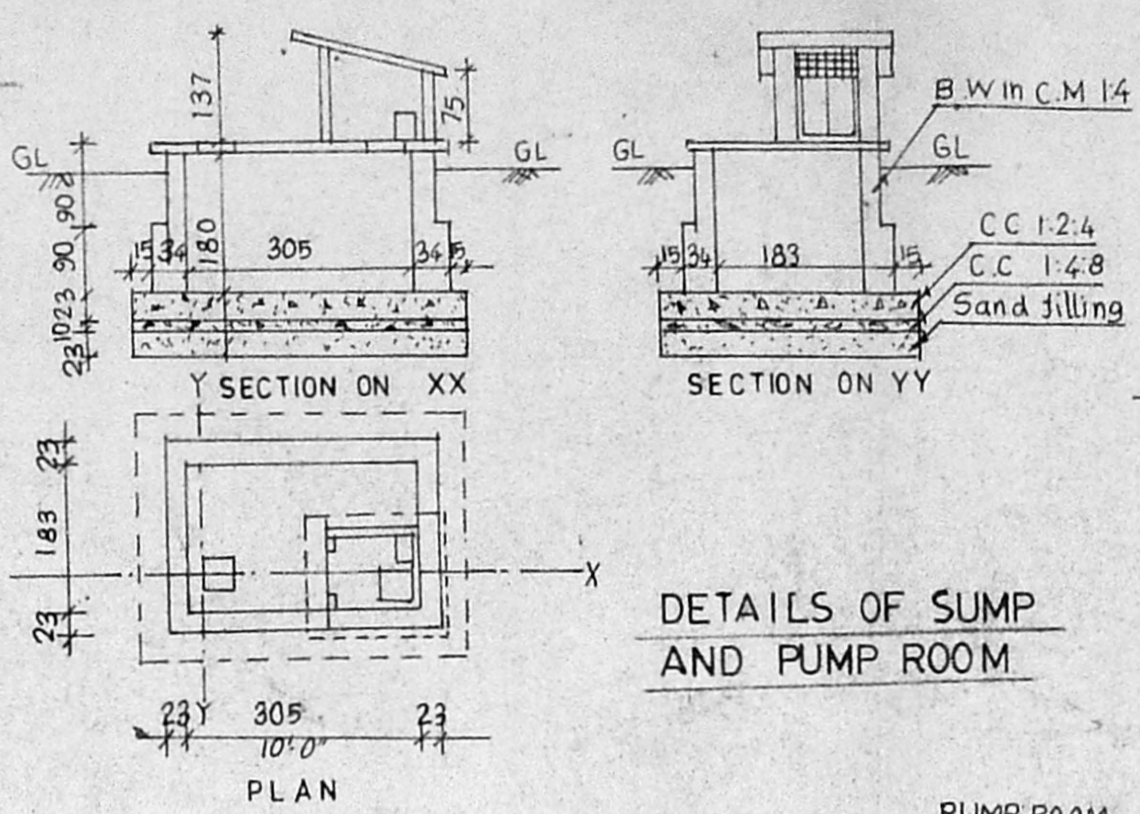

DETAILS OF SUMP AND PUMP ROOM

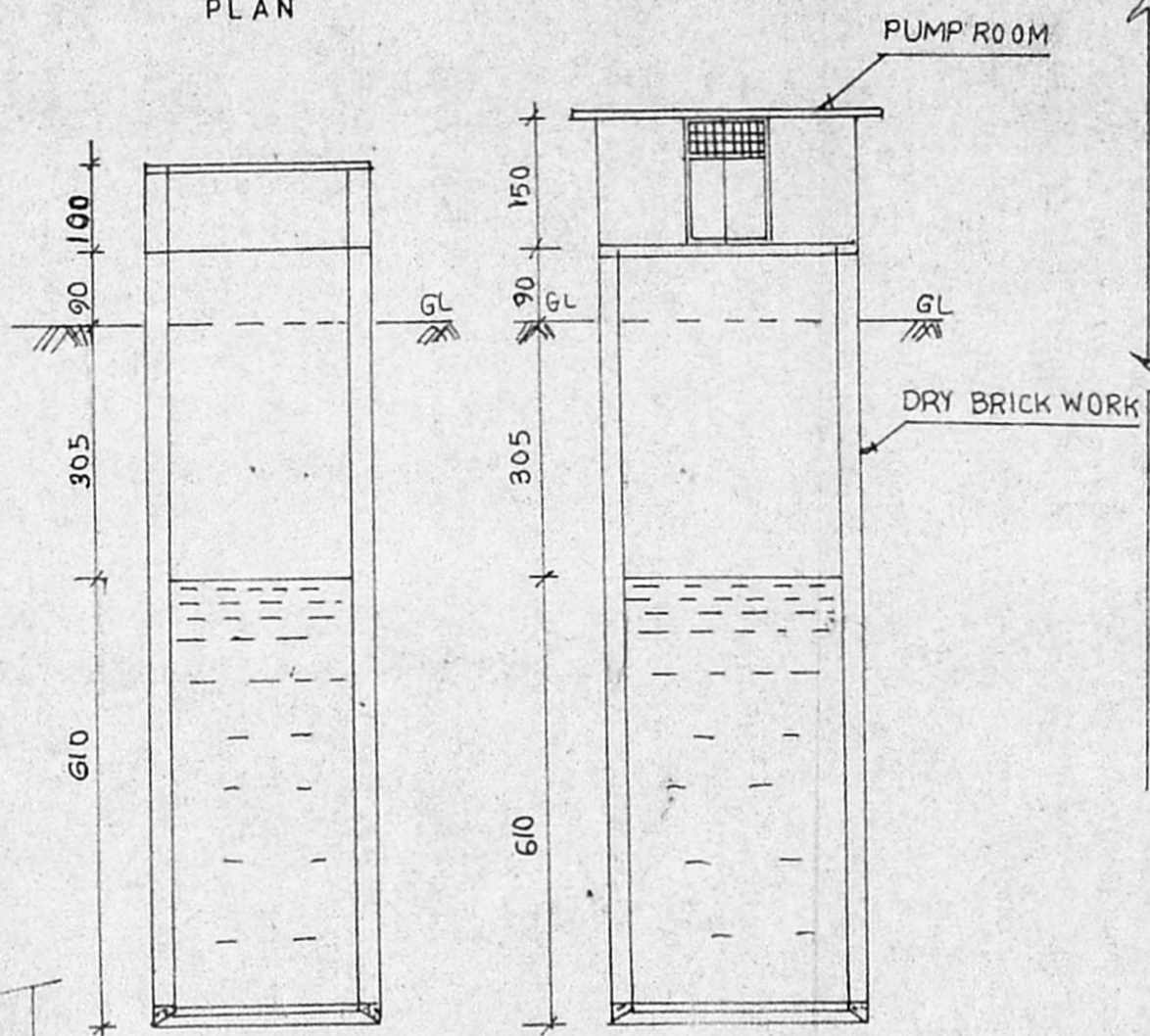

DETAILS OF RAIN WATER DRAIN BED

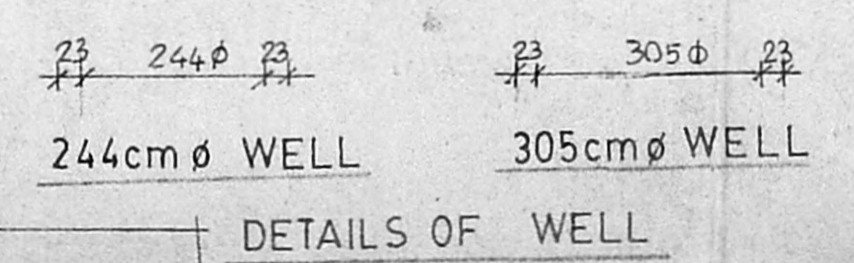

DETAILS OF WELL

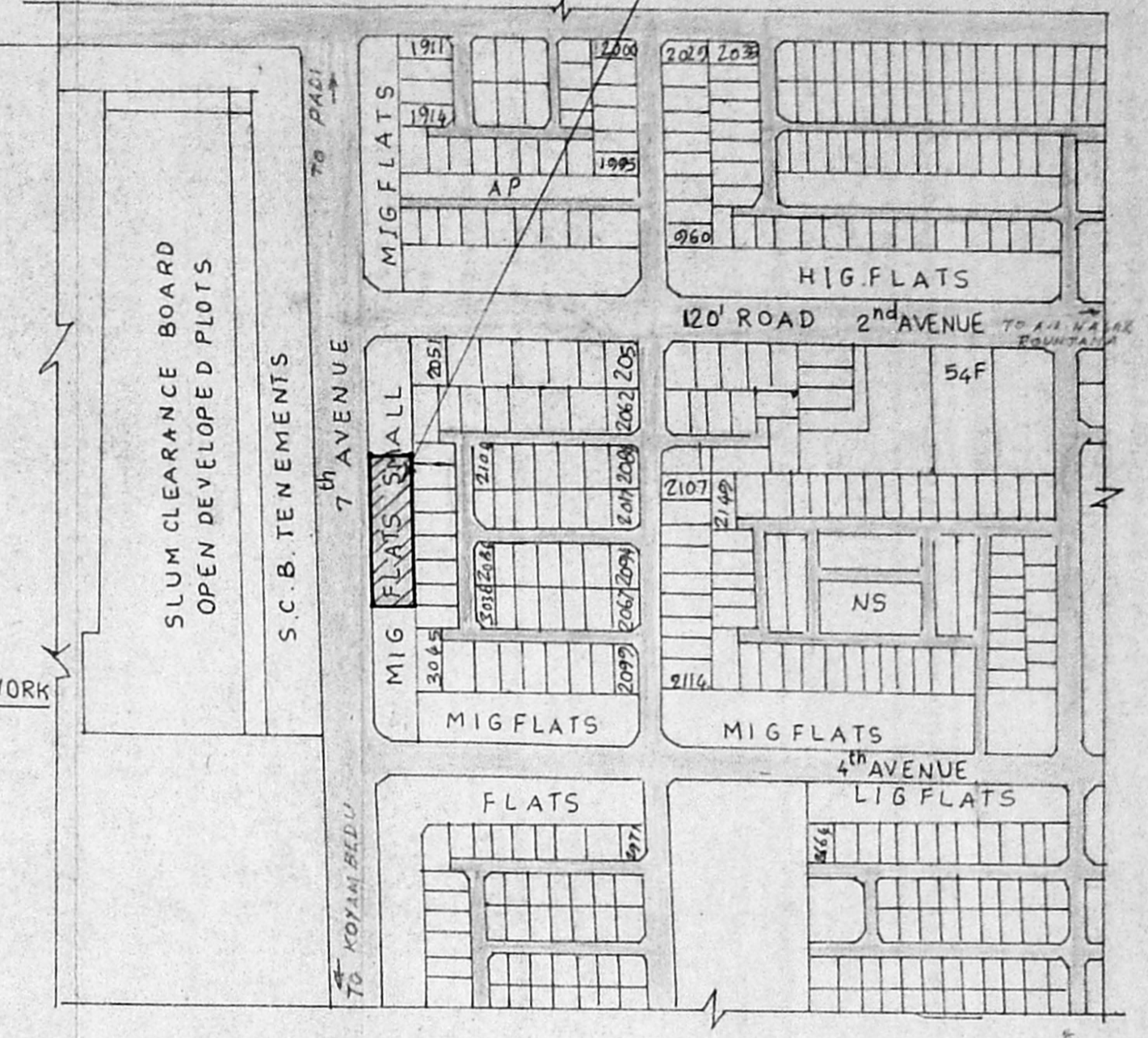

SITE PLAN (SCALE 1"=330')

- REFERENCE
- EXISTING BUILDINGS
  - PROPOSED ADDITIONS
  - ROADS
  - SITE BOUNDARY

*S. Jan Muhammad*  
 (SECRETARY)  
 SYED JAN MUHAMMAD

OWNER SIGNATURE

APOLLO FLATS WELFARE ASSOCIATION  
 214/86, E to I BLOCKS,  
 7<sup>th</sup> AVENUE, ANNA NAGAR,  
 MADRAS-600 040.

*S. Anantha Chari*  
 S. ANANTHACHARI, P.I.R.A. MISE.,  
 Registered Architect & Engineer No. 0-1  
 Class-I Licensed Surveyor No. 10-1  
 CORPORATION O. M. S. S.  
 113-4, SOUTH TANK SQUARE  
 Triplicane, Madras - 600 008.

LICENSED SURVEYOR

AREA DETAILS			
E BLOCK	EXISTING	PROPOSED	TOTAL
GROUND FLOOR	93.30M <sup>2</sup> + 78.38M <sup>2</sup> = 171.68M <sup>2</sup> (46.65 x 2) (39.19 x 2)	(85.84 x 2)	
FIRST FLOOR	93.30M <sup>2</sup> + 78.38M <sup>2</sup> = 171.68M <sup>2</sup> (46.65 x 2) (39.19 x 2)	(85.84 x 2)	
SECOND FLOOR	93.30M <sup>2</sup> + 78.38M <sup>2</sup> = 171.68M <sup>2</sup> (46.65 x 2) (39.19 x 2)	(85.84 x 2)	
<b>F, G &amp; H BLOCKS</b>			
GROUND FLOOR	278.34M <sup>2</sup> + 232.68M <sup>2</sup> = 511.02M <sup>2</sup> (46.39 x 6) (38.78 x 6)	(85.17 x 6)	
FIRST FLOOR	278.34M <sup>2</sup> + 232.68M <sup>2</sup> = 511.02M <sup>2</sup> (46.39 x 6) (38.78 x 6)	(85.17 x 6)	
SECOND FLOOR	278.34M <sup>2</sup> + 232.68M <sup>2</sup> = 511.02M <sup>2</sup> (46.39 x 6) (38.78 x 6)	(85.17 x 6)	
<b>I BLOCK</b>			
GROUND FLOOR	93.30M <sup>2</sup> + 78.38M <sup>2</sup> = 171.68M <sup>2</sup> (46.65 x 2) (39.19 x 2)	(85.84 x 2)	
FIRST FLOOR	93.30M <sup>2</sup> + 78.38M <sup>2</sup> = 171.68M <sup>2</sup> (46.65 x 2) (39.19 x 2)	(85.84 x 2)	
SECOND FLOOR	93.30M <sup>2</sup> + 78.38M <sup>2</sup> = 171.68M <sup>2</sup> (46.65 x 2) (39.19 x 2)	(85.84 x 2)	
TOTAL FLOOR AREA (EXISTING + PROPOSED)			
E + F, G, H + I BLOCKS	515.04 + 1533.06 + 515.04		= 2563.14 M <sup>2</sup>
TOTAL SITE EXTENT 3162.85M <sup>2</sup>			
TOTAL PLINTH AREA 854.38M <sup>2</sup>			
VACANT AREA 2308.47M <sup>2</sup>			
PLOT COVERAGE 27.0%			
F.S.I 0.81			

THE PROPOSED ADDL. CONTN. OF T'N H B MUG. FLATS (Nos. E-1 TO E-6, F1 TO F6; I-1 TO H-6 & I-1 TO I-6) IN BLOCK Nos. E, F, G, H & I, OF APOLLO FLATS, AT ARINGAR 7th AVENUE, IN S. NO. 226, THIRUMANGALAM VILLAGE, (KOYAMBEDU COMES UNDER THIRUMANGALAM V) CORPORATION DIVISION NO. 64. (NEW) [SCALE 1"=8'0" (1:100)]

AREA DETAILS

TOTAL SITE EXTENT OF APOLLO FLATS	3162.85 M <sup>2</sup>
PLINTH AREA OF BLOCK E } (EXISTING G-FLOOR, F-FLOOR, S-FLOOR)	279.90 M <sup>2</sup>
PLINTH AREA OF BLOCK F, G, H } (EXISTING G-FLOOR, F-FLOOR, S-FLOOR)	835.02 M <sup>2</sup>
PLINTH AREA OF BLOCK I } (EXISTING G-FLOOR, F-FLOOR, S-FLOOR)	279.90 M <sup>2</sup>
TOTAL PLINTH AREA (EXG.) } E, F, G, H & I. BLOCKS	1394.82 M <sup>2</sup>
PLINTH AREA OF BLOCK E } (PROPOSED G-FLOOR, F-FLOOR, S-FLOOR)	235.14 M <sup>2</sup>
PLINTH AREA OF BLOCK F, G, H } (PROPOSED G-FLOOR, F-FLOOR, S-FLOOR)	595.04 M <sup>2</sup>
PLINTH AREA OF BLOCK I } (PROPOSED G-FLOOR, F-FLOOR, S-FLOOR)	235.14 M <sup>2</sup>
TOTAL PLINTH AREA (PROJ.) } E, F, G, H & I BLOCKS	1168.32 M <sup>2</sup>

COLOUR INDEX

EXISTING BUILDING	[Symbol]
PROPOSED EXTN.	[Symbol]
EXISTING ROAD	[Symbol]
SITE BOUNDARY	[Symbol]

APOLLO FLATS WELFARE ASSOCIATION  
214/46, E 10 I BLOCKS,  
7th AVENUE, ANNA NAGAR,  
MADRAS-600 040.

OWNER'S SIGNATURE

REVISIONS

Revised Plan  
Dt. 28.02.91

ANANTHACHARI, F.I.R. 2  
Registered Architect & Surveyor No. C  
Class-I Licensed Surveyor No. 10  
CORPORATION DIVISION NO. 64  
13-4 SOUTH TANK SQUARES  
Triplicane, Madras-600 006

LICENSED SURVEYOR

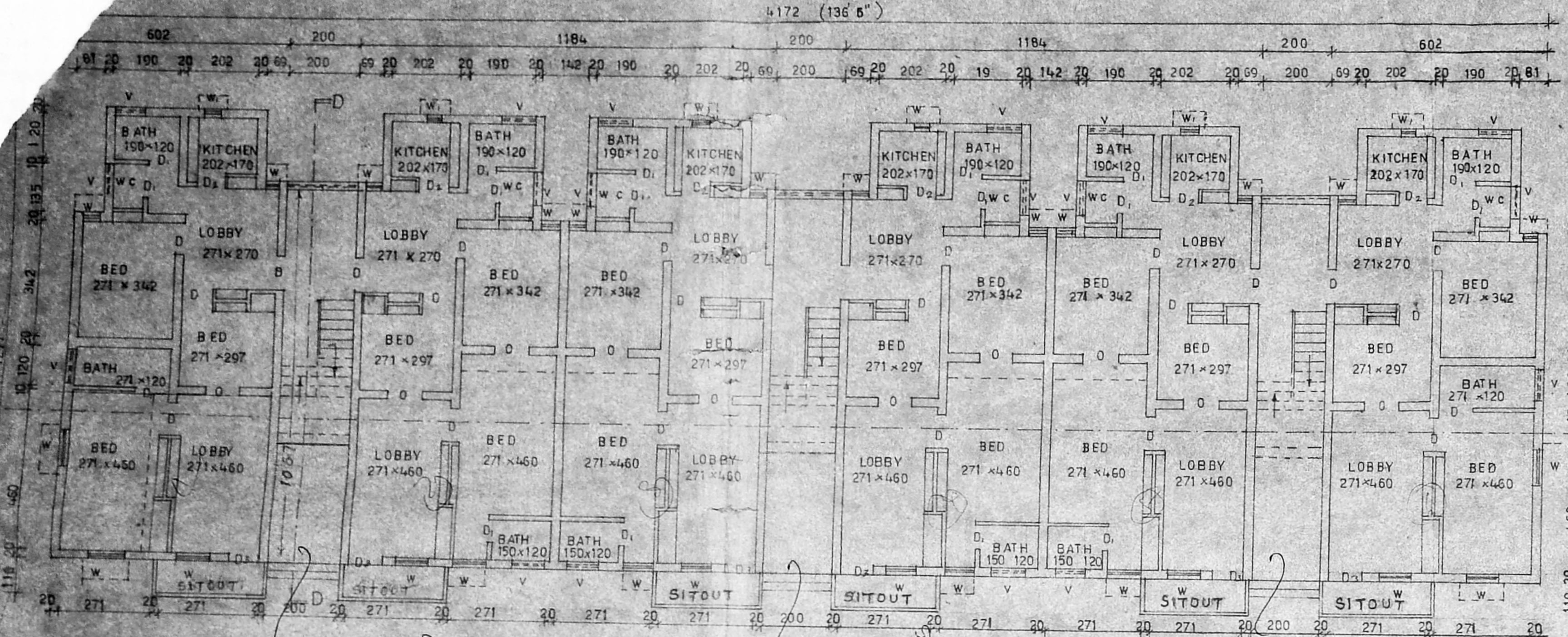

GROUND FLOOR PLAN OF BLOCK Nos. F, G & H (FLAT Nos. F-1 to F-2, G-1 to G-2 & H-1 to H-2)

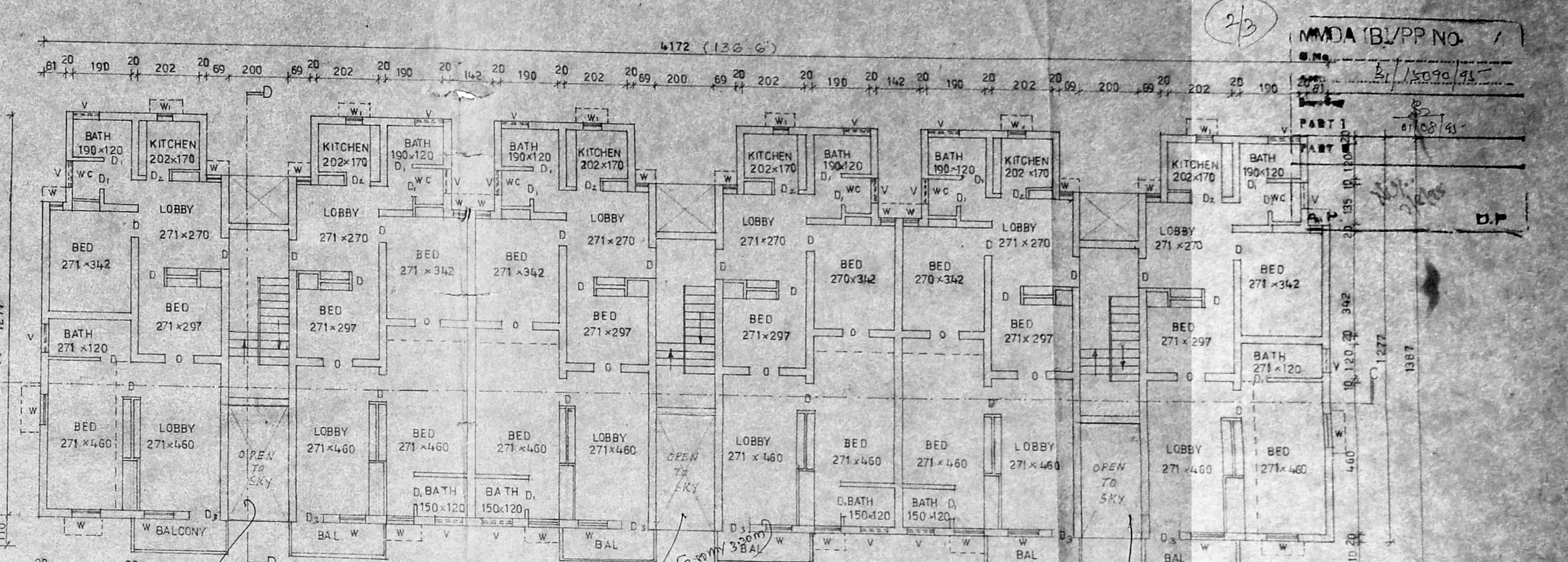

TYPICAL FLOOR PLAN OF BLOCK Nos. F, G & H (FIRST FLOOR / SECOND FLOOR) (FLAT Nos. F-3 TO F-6, G-3 TO G-6 & H-3 TO H-6)

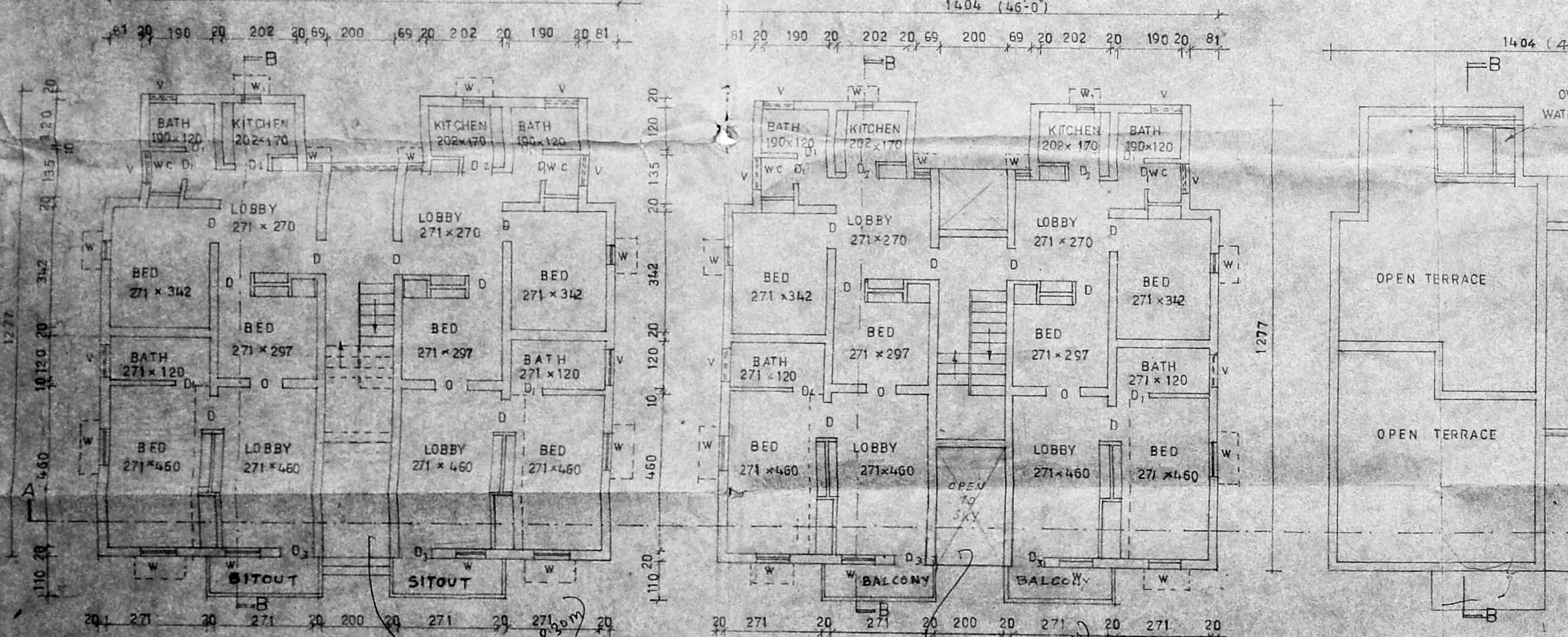

GROUND FLOOR PLAN OF BLOCK No. E/I (FLAT Nos. E-1 to E-2 & I-1 to I-2)

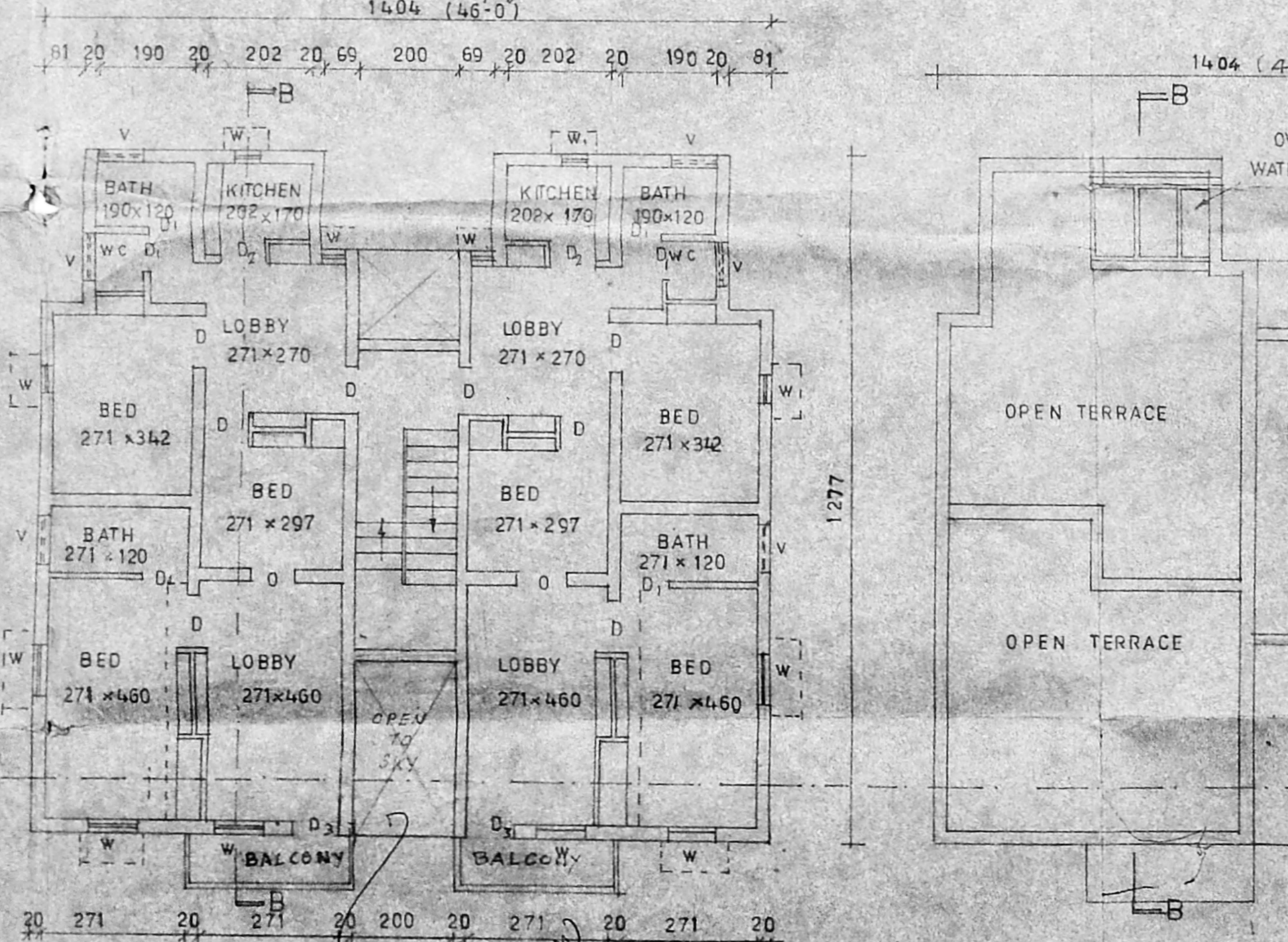

TYPICAL FLOOR PLAN OF BLOCK No. E/I (FIRST FLOOR / SECOND FLOOR) (FLAT Nos. E-3 to E-6 & I-3 to I-6)

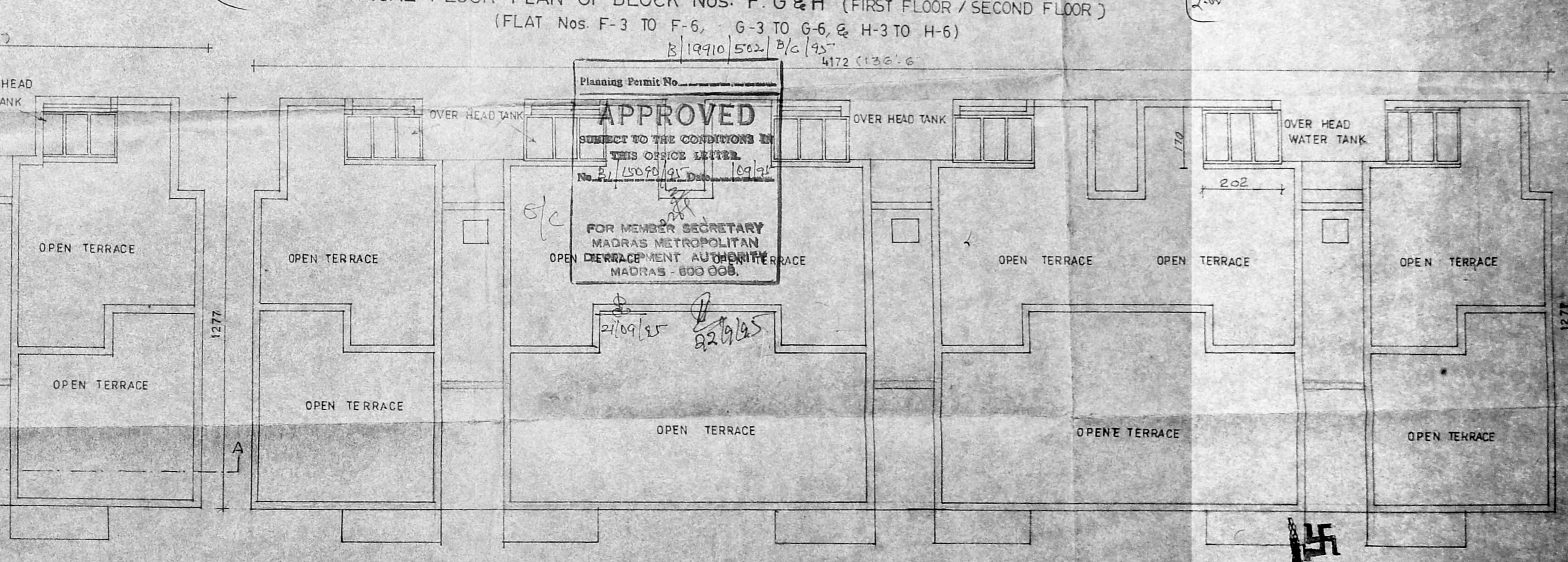

TERRACE FLOOR PLAN OF BLOCK NO. E/I

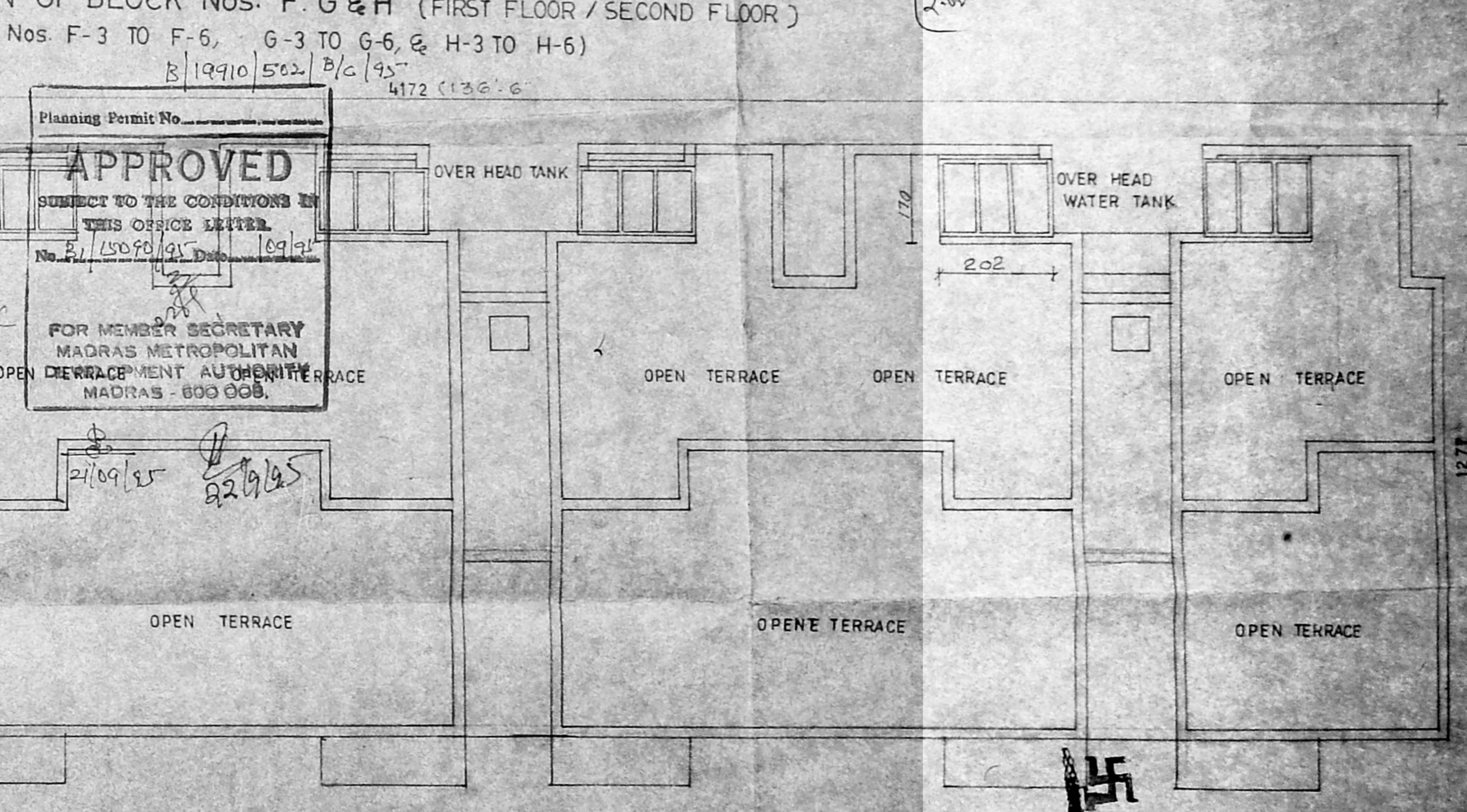

TERRACE FLOOR PLAN OF BLOCK Nos. F, G, H

B/19910/502/4c/95

Planning Permit No. **APPROVED**  
 SUBJECT TO THE CONDITIONS IN THIS OFFICE LETTER  
 No. B/15090/95 Date 08/31

FOR MEMBER SECRETARY  
 MADRAS METROPOLITAN  
 DEVELOPMENT AUTHORITY  
 MADRAS-600 008.

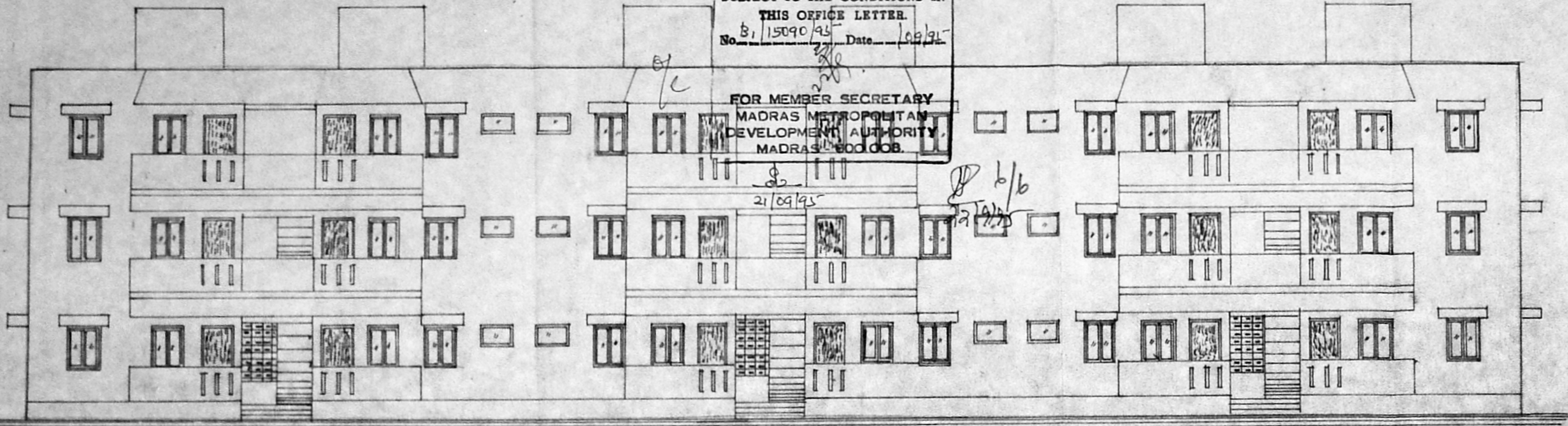

ELEVATION OF BLOCK NO F G H

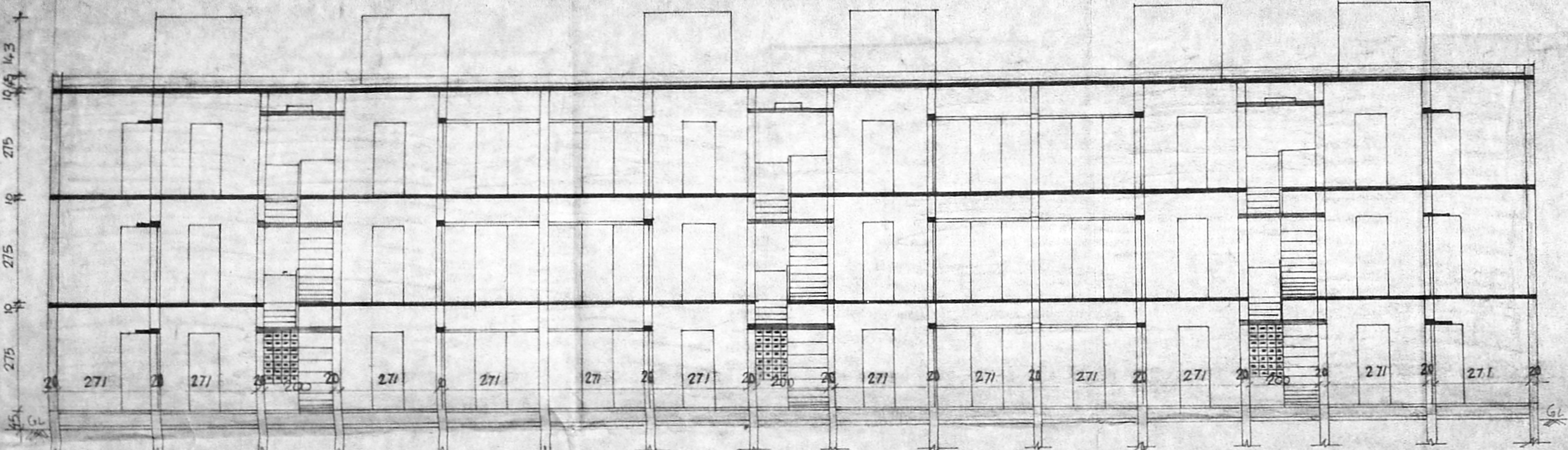

SECTION ON CC (BLOCK NO F G H)

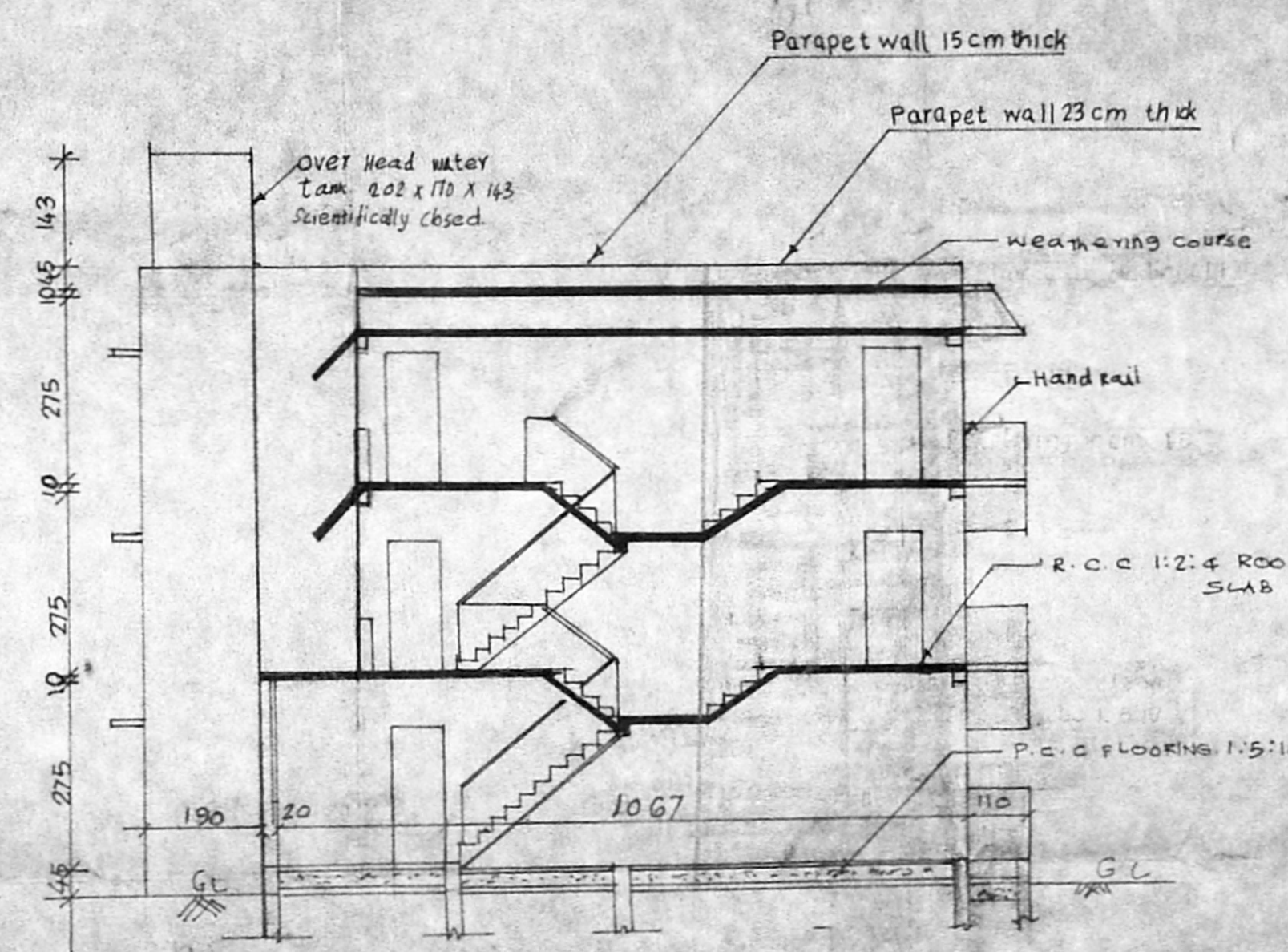

SECTION ON DD

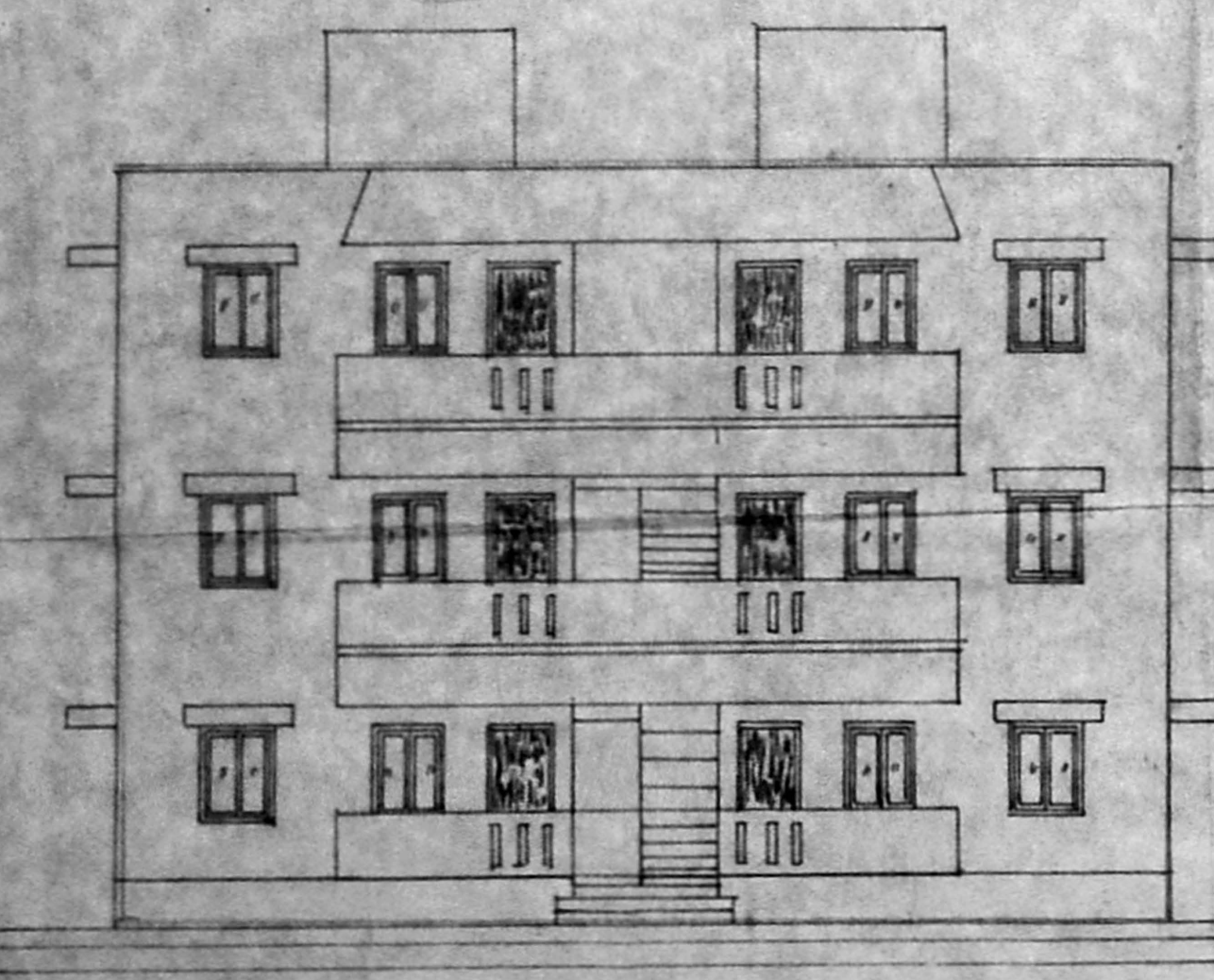

ELEVATION OF BLOCK NO E & I

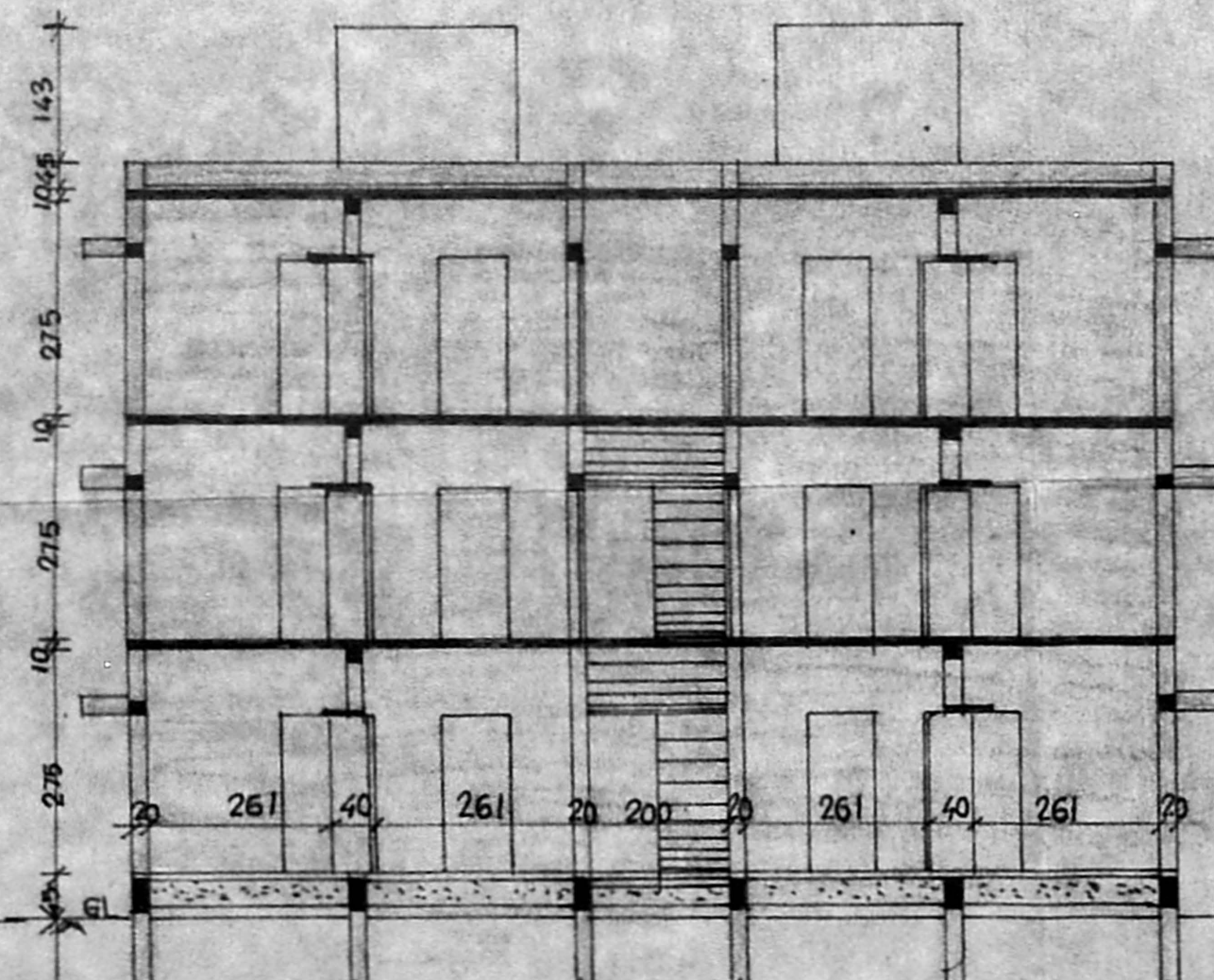

SECTION ON AA

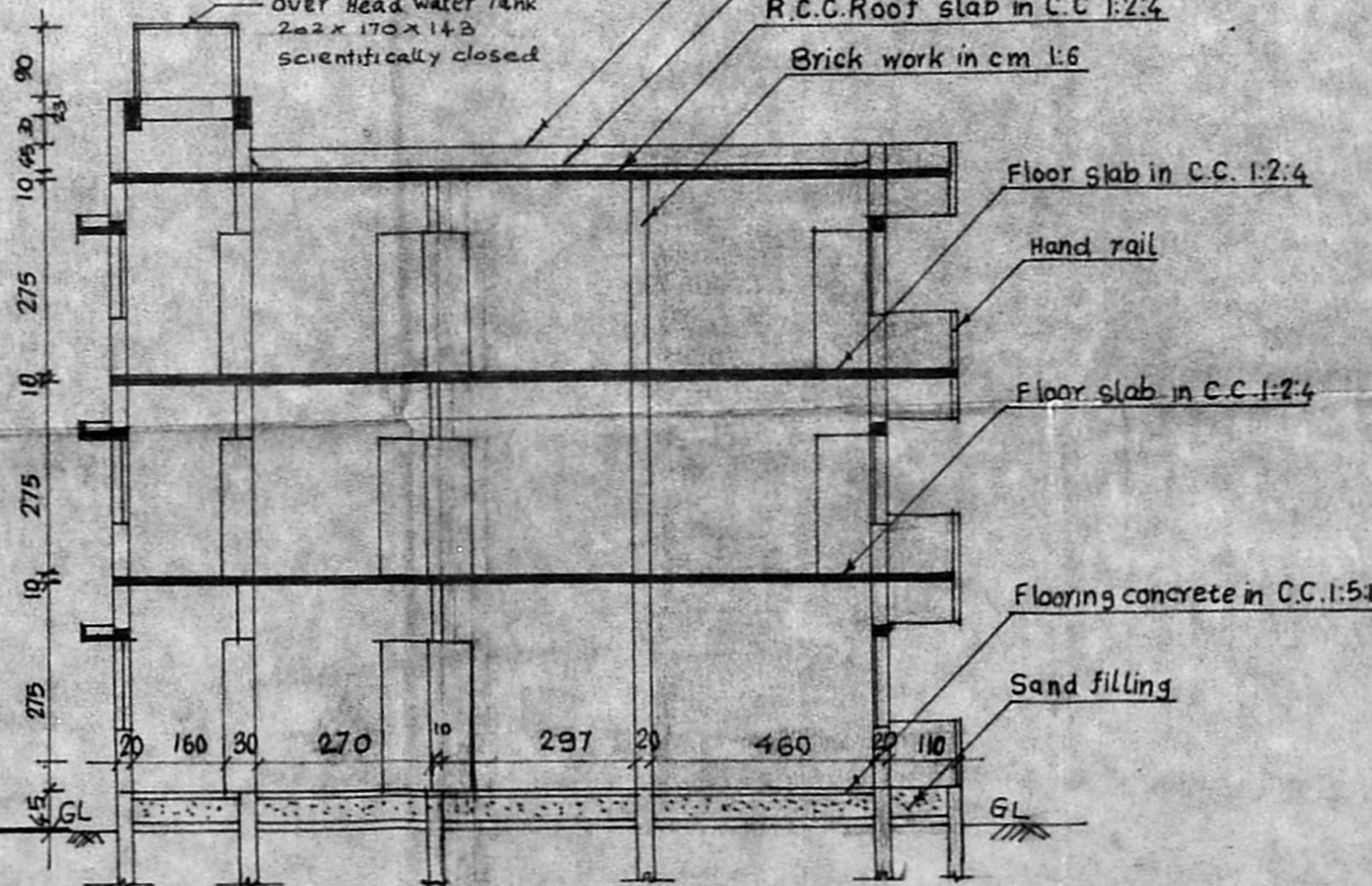

SECTION BB

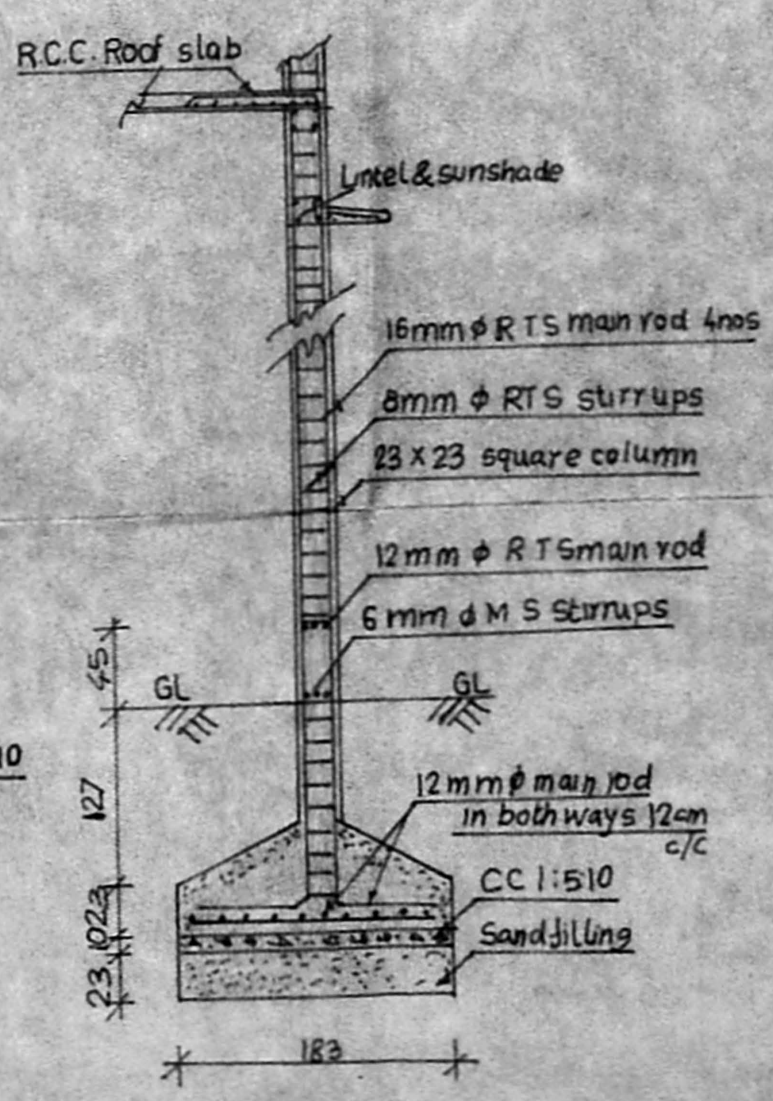

FOUNDATION DETAILS

SCHEDULE OF JOINERIES

D	DOOR	90 X 200 CM
D <sub>1</sub>	DOOR	MADA 75 X 200 CM
D <sub>2</sub>	DOOR	75 X 200
D <sub>3</sub>	DOOR	100 X 200
W	WINDOW	90 X 120
W <sub>1</sub>	WINDOW	47.5 X 120
W <sub>2</sub>	WINDOW	120 X 120
V	VENTILATOR	90 X 60
V <sub>1</sub>	R.C.C. JALLI	60 X 70
W <sub>3</sub>	WINDOW	150 X 120
O	OPENING	90 X 200

COLOUR INDEX

EXISTING BUILDING	<input type="checkbox"/>
PROPOSED EXTENSION	<input type="checkbox"/>
EXISTING ROAD	<input type="checkbox"/>
SITE BOUNDARY	<input type="checkbox"/>

PLAN OF PROPOSED ADDITIONS TO THE EXISTING T.N.H.B M.I.G FLATS (Nos. E-1 TO E-6, F-1 TO F-6, G-1 TO G-6, H-1 TO H-6, AND I-1 TO I-6) IN BLOCK Nos. E, F, G, H & I OF APOLLO COLONY AT ANNA NAGAR, 7<sup>th</sup> AVENUE, IN S. No. 226 P. THIRUMANGALAM VILLAGE, MADRAS CORPORATION DIVN. NO. 64 [SCALE 1" = 8' 0" (1:100)]

(SECRETARY) APOLLO FLATS WELFARE ASSOCIATION  
 SYED JAN MUHAMMAD  
 214/86, E to I BLOCKS,  
 7<sup>th</sup> AVENUE, ANNA NAGAR,  
 MADRAS-600 040.

OWNER SIGNATURE

S. ANANTHACHARI, F.I.I.R. A.M.I.S.E.,  
 Registered Architect & Engineer No. C.A. 2384,  
 Class-I Licensed Surveyor No. R.A. 25,  
 CORPORATION OF MADRAS,  
 1/3-A, SOUTH TANK SQUARE STREET,  
 Triplicane, Madras - 600 005  
 LICENSED SURVEYOR